



PRONAR Sp. z o.o.

17-210 NAREW, UL. MICKIEWICZA 101A, PODLASKIE PROVINCE

phone: +48 085 681 63 29

+48 085 681 63 81

fax: +48 085 681 63 83

+48 085 681 64 29

+48 085 681 63 82

+48 085 682 71 10

www.pronar.pl

OPERATOR'S MANUAL

FRONT LOADER IMPLEMENTS

TYPE OF ATTACHMENT: LC-1650; EURO; SMS; JCB; WEIDEMANN

PALLET FORK

PRONAR 35WP / 35WP1 / 35WP2 / WP-25E

TRANSLATION OF THE ORIGINAL COPY OF THE MANUAL

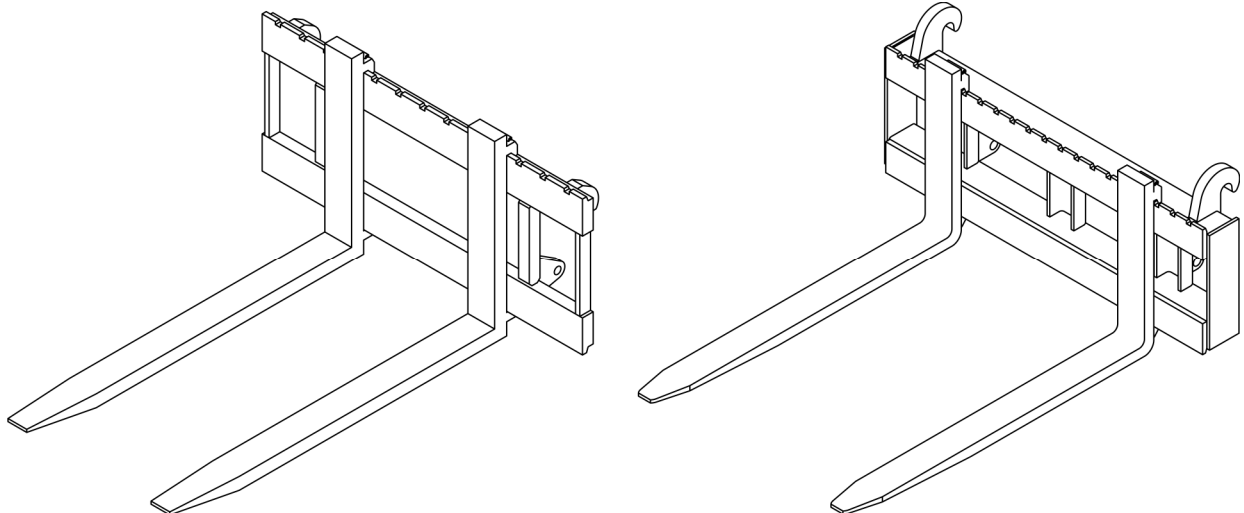

EDITION 4A-05-2017

PUBLICATION NO 35N-26000000-UM



FRONT LOADER IMPLEMENTS

TYPES OF ATTACHMENT: LC-1650; EURO; SMS; JCB; WEIDEMANN

PRONAR 35WP / 35WP1 / 35WP2 / WP-25E PALLET FORKS

MACHINE IDENTIFICATION

TYPE:

SERIAL NUMBER:

--	--	--	--	--	--

INTRODUCTION

The information contained in the publication is current as at the date of publication. As a result of improvement, some sizes and illustrations contained in this publication may not correspond to the actual state of the machine delivered to the user. The manufacturer reserves the right to introduce constructional changes in the manufactured machines to facilitate operation and improve the quality of their work, without making any current changes to this publication.

The operating instruction is the basic equipment of the machine. Before using the machine, the user must read the contents of this manual and observe all recommendations contained therein. This will guarantee safe and trouble-free operation of the machine. The machine was constructed in accordance with applicable standards, documents and current legal regulations. The operating instruction describes the basic principles of safe use and operation of the accessories. If the information contained in the operating instructions does not turn out to be comprehensible, please contact the sales office where the machine was purchased or the Manufacturer.

MANUFACTURER'S ADDRESS

*PRONAR Sp. z o.o.
ul. Mickiewicza 101A
17-210 Narew*

CONTACT PHONE NUMBERS

<i>+48 085 681 63 29</i>	<i>+48 085 681 64 29</i>
<i>+48 085 681 63 81</i>	<i>+48 085 681 63 82</i>

SYMBOLS USED IN THE MANUAL

Information, descriptions of hazards and precautions as well as instructions and orders related to safe use in the manual are marked with:



and preceded by the word „**DANGER**”. Failure to comply with these recommendations may endanger the health or life of persons operating the machine or unauthorized bystanders.

Particularly important information and recommendations, the observance of which is absolutely necessary, are highlighted in the text with a sign:



and preceded by the word „**CAUTION**”. Failure to comply with these recommendations creates the risk of damage to the machine due to improper handling, adjustment or use.

In order to draw the user's attention to the necessity to perform periodic maintenance, the content of the manual is marked with the following sign:



Additional instructions contained in the manual describe useful information on operating the machine and are marked with a sign:



and preceded by the word „**ADVICE**”.

DESIGNATION OF DIRECTIONS IN THE MANUAL

Left side – the left hand side of the observer facing the machine in the forward direction.

Right side – the right hand side of the observer facing the machine in the forward direction.



PRONAR Sp. z o.o.

ul. Mickiewicza 101 A

17-210 Narew, Polska

tel./fax (+48 85) 681 63 29, 681 63 81, 681 63 82,
681 63 84, 681 64 29

fax (+48 85) 681 63 83

<http://www.pronar.pl>

e-mail: pronar@pronar.pl

EC DECLARATION OF CONFORMITY OF THE MACHINERY

PRONAR Sp. z o.o. declares with full responsibility, that the machine:

Description and identification of the machinery			
Generic denomination and function:	Pallet fork		
Type:	35WP	35WP1	WP-25E
Model:	—	—	—
Serial number:			
Commercial name:	Pallet fork PRONAR 35WP Pallet fork PRONAR 35WP1 Pallet fork PRONAR WP-25E		

to which this declaration relates, fulfills all the relevant provisions of the Directive **2006/42/EC** of The European Parliament and of The Council of 17 May 2006 on machinery, and amending Directive 95/16/EC (Official Journal of the EU, L 157/24 of 09.06.2006).

The person authorized to compile the technical file is the Head of Research and Development Department at PRONAR Sp. z o.o., 17-210 Narew, ul. Mickiewicza 101A, Poland.

This declaration relates exclusively to the machinery in the state in which it was placed on the market, and excludes components which are added and/or operations carried out subsequently by the final user.

Narew, the 2011 -03- 24

Place and date

Z-CIA DZIEKTORA
d/s technicznych
członek zarządu

Roman Ochotniuk

*Full name of the empowered person
position, signature*

TABLE OF CONTENTS

1	BASIC INFORMATION	1.1
1.1	IDENTIFICATION	1.2
1.2	INTENDED USE	1.3
1.3	EQUIPMENT	1.4
1.4	TERMS OF WARRANTY	1.4
1.5	TRANSPORT	1.6
1.6	WITHDRAWAL FROM USE	1.7
2	GENERAL SAFETY RULES	2.1
2.1	GENERAL SAFETY RULES	2.2
2.1.1	USE OF THE EQUIPMENT	2.2
2.1.2	COUPLING AND UNCOUPLING OF THE EQUIPMENT	2.3
2.1.3	TRANSPORT PASSAGE	2.3
2.1.4	MAINTENANCE	2.4
2.1.5	WORK WITH EQUIPMENT	2.5
2.2	DESCRIPTION OF RESIDUAL RISK	2.6
2.3	INFORMATION AND WARNING STICKERS	2.7
3	DESIGN AND OPERATION	3.1
3.1	TECHNICAL CHARACTERISTICS	3.2
3.2	GENERAL CONSTRUCTION	3.3
4	CORRECT USE	4.1
4.1	PREPARATION TO WORK	4.2
4.2	ATTACHING OF THE EQUIPMENT TO THE LOADER	4.3
4.3	WORK WITH EQUIPMENT	4.5

4.4 UNCOUPLING EQUIPMENT FROM THE LOADER	4.9
4.5 TRANSPORT PASSAGE	4.9
5 MAINTENANCE	5.1
5.1 MAINTENANCE AND STORAGE	5.2
5.2 TROUBLESHOOTING	5.3

SECTION

1

BASIC INFORMATION

1.1 IDENTIFICATION

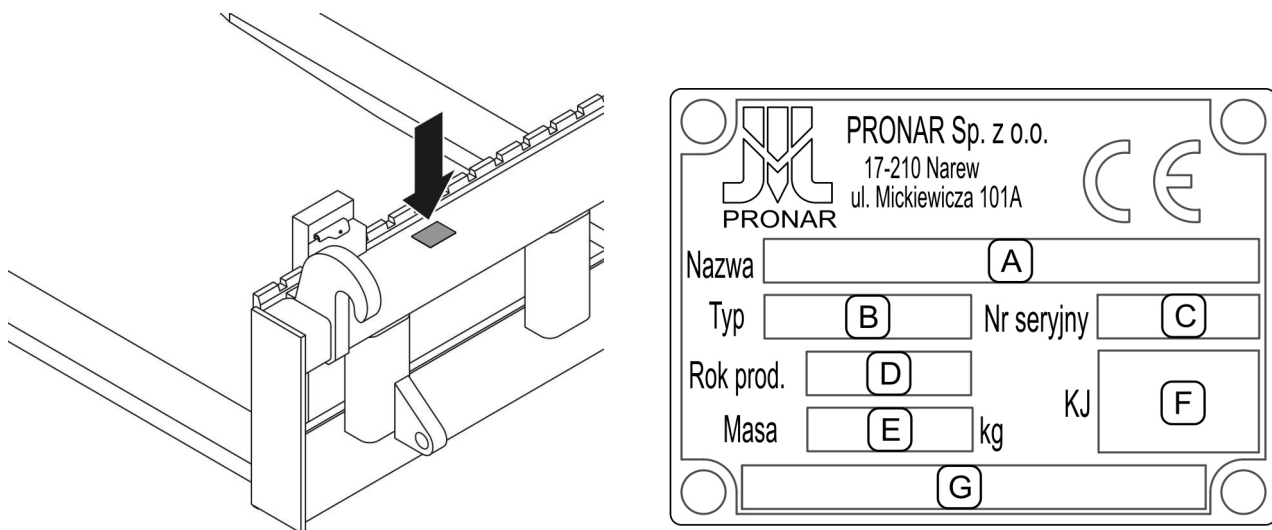

FIG. 1.1 Location of the nameplate

Meaning of the individual nameplate fields (FIG. 1.1):

- A - machine name
- B - type
- C - serial number
- D - year of machine production
- E - the machine's karb weight[kg]
- F - Quality Control mark
- G – Additional information

The serial number is stamped on the nameplate and on the attachment frame next to the nameplate. The nameplate is located on the upper frame beam (FIG. 1.1). When purchasing the machine, check that the serial numbers on the machine match the number entered in the *WARRANTY CARD*, in the sales documents and in the *USER MANUAL*.

1.2 INTENDED USE

The attachments covered by this manual are intended for the LC-1650 front loaders, loaders equipped with EURO mount system, SMS, JCB2CX backhoe loaders and WEIDEMANN 2070CX50 loaders. Pallet forks are used to load and unload pallets and crates. With a special grapple (*CK or CKE*), the forks can be used to load logs of wood (*35WP and 35WP1 forks only*). The fork can only be used to transport the above-mentioned materials over short distances. Use for other purposes is not in accordance with the intended purpose.

Intended use also includes all activities related to the correct and safe operation and maintenance of the machine. Therefore, the user is obliged to:

- get acquainted with the contents of the *USER MANUAL* and comply with its recommendations,
- understand the principle of machine operation and the safe and proper operation,
- work in compliance with general safety regulations,
- accident prevention,
- comply with traffic regulations.

The machine may only be used by persons who:

- are familiar with the content of this publication and with the content of the carrier's manual
- have been trained in operation and work safety,
- they have the required authorisations to drive the vehicle.

CAUTION

The machine may not be used for purposes other than those for which it is intended in particular:

- transport people and animals,
- use for the transport and handling of materials other than those provided for in the manual.

TAB. 1.1 Front loader requirements

	REQUIREMENTS
Tool mounting system	EURO (<i>for 35WP1 and WP-25E forks</i>) EURO SMS (<i>for fork 35WP2 and WP-25SMS</i>) LC-1650 (<i>for 35WP forks</i>) JCB2CX (<i>applies to WP-25JCB forks</i>) WEIDEMANN 2070CX50 (<i>for WP-25WEIDEMANN forks</i>)
Hydraulic system for equipment controlling	NO

1.3 EQUIPMENT

The equipment includes

- User manual;
- Warranty Card;

1.4 TERMS OF WARRANTY

PRONAR Sp. z o.o. in Narew guarantees smooth operation of the machine when it is used in accordance with the technical and operational conditions described in the *USER MANUAL*. Defects revealed during the warranty period will be removed by the Warranty Service. Deadline for completion of repairs is specified in the *WARRANTY CARD*.

The warranty does not apply to parts and sub-assemblies of the machine, which are subject to wear in normal operating conditions, regardless of the warranty period.

The warranty services only apply to such cases as: mechanical damage not caused by the fault of the user, factory defects of parts, etc.

In the event that damage occurs as a result of:

- mechanical damage caused by the user's fault, road accident,
- from improper operation, adjustment and maintenance, use of the machine contrary to its purpose,
- use of damaged or inefficient machine,
- repairs carried out by unauthorized persons, improper repairs,
- execution of user changes in machine design, the user loses the warranty.



ADVICE

You should require the seller to carefully fill out the **WARRANTY CARD** and complaint coupons. The lack of e.g. date of sale or point of sale stamp exposes the user to not accept any complaints.

The user is obliged to immediately report all noticed defects in the paint coatings or traces of corrosion, and order removal of defects regardless of whether the damage is covered by the warranty or not. Detailed warranty conditions are given in the **WARRANTY CARD** attached to the newly purchased machine.

Modifications to the machine without the written consent of the Manufacturer are prohibited. In particular, it is unacceptable to weld, bore, cut or heat the main structural elements, which directly affect the safety of work with the machine.

1.5 TRANSPORT

The equipment is ready for sale completely assembled and does not require packing. Packing is required only for the machine's technical and operational documentation. Delivery to the user can be carried out by road transport or independent transport.



DANGER

It is forbidden to transport the equipment suspended on the front loader on public roads.

When transporting by vehicle, the equipment should be securely fastened to the loading platform using certified belts or chains equipped with a tensioning mechanism.



DANGER

When transporting by car, secure the machine to the transport means platform in accordance with the safety requirements during transport. The car driver should exercise extreme caution when transporting the machine. This is due to the vehicle's centre of gravity shifting upwards with the machine loaded.

When loading and unloading, comply with the general principles of workplace health and safety for reloading work. Persons operating reloading have required permissions to use these devices.

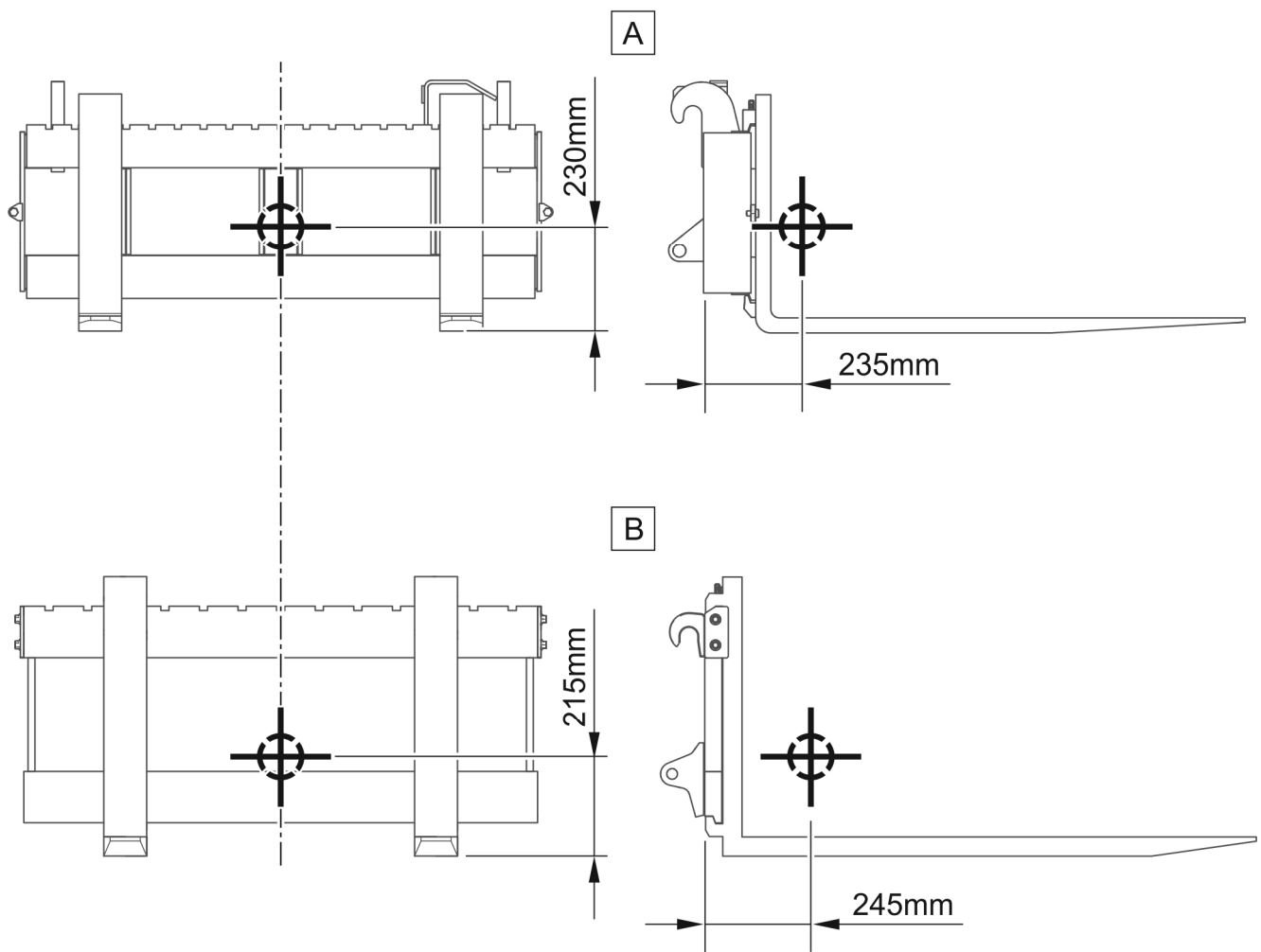

FIG. 1.2 Centre of gravity (fork arms symmetrically spaced)

(A) - Pallet fork 35WP / 35WP1 / 35WP2; (B) - Pallet fork WP-25E



CAUTION

The location of the center of gravity depending on the implement model may deviate within ± 25 mm from the values given above.

1.6 WITHDRAWAL FROM USE

If the user decides to withdraw the equipment from use, comply with the provisions in force in the given country regarding withdrawal from use and recycling of machines withdrawn from use.

Pallet forks can be scrapped completely because they consist of only steel components and do not need to be disassembled before destruction.

CHAPTER

2

**GENERAL SAFETY
RULES**

2.1 GENERAL SAFETY RULES

2.1.1 USE OF THE EQUIPMENT

- Before using the user should carefully read the content of this document and the WARRANTY CARD. During their operation, all recommendations contained therein must be observed.
- The equipment may only be used and operated by persons authorized to drive agricultural tractors and agricultural machines and trained in the use of attachments.
- If the information contained in the User's Manual is difficult to understand, contact a seller who runs an authorized technical service on behalf of the manufacturer, or contact the manufacturer directly.
- Careless and improper use and operation of the equipment, non-observance of the recommendations contained in these instructions creates a threat to health.
- Be aware of the existence of a residual risk of hazards, therefore the basic principle of using the equipment should be the application of the principles of safe use and reasonable behaviour.
- The equipment must not be used by persons who are not authorized to drive the carrier, including children, people under the influence of alcohol and drugs or other intoxicating substances.
- Non-compliance with the rules of safe use poses a threat to the health of the operating and bystanders.
- It is forbidden to use the equipment inconsistently with their intended use. Everyone who uses the machine in a manner contrary to its intended use, thus takes full responsibility for all consequences arising from its use. Use of the machine for purposes other than envisaged by the Manufacturer is inconsistent with the purpose of the machine and may void the warranty.
- The equipment may only be used when all safety elements, including warning signs, are technically sound and correctly positioned. In the event of damage or loss of safety elements, they must be replaced with new ones.

2.1.2 COUPLING AND UNCOUPLING OF THE EQUIPMENT

- Do not connect equipment to the loader unless the equipment attachment system is compatible with the loader attachment system.
- Be especially careful when coupling the equipment to the loader.
- After the attachment is completed, check the safety features. Read the loader operating instructions.
- The loader with which the equipment works must be technically efficient and must meet the requirements set by the manufacturer of the equipment.
- When coupling, there must be nobody between the equipment and the loader.
- Before disconnecting from the loader, the equipment must be emptied.
- Be especially careful when uncoupling the equipment.
- The equipment disconnected from the loader must be placed on a level, sufficiently hard surface in such a way that it can be coupled again.

2.1.3 TRANSPORT PASSAGE

- The maximum transport speed of 15 km/h (i.e., unladen speed) should not be exceeded. Adjust speed driving to road conditions.
- It is forbidden to transport people and animals in accessories.
- During transport, the loader boom should be blocked against accidental use.
- All journeys and access during reloading should take place with the implement lowered down, so that it does not obstruct visibility and at the same time does not rub against the ground.
- Reckless driving and excessive speed can cause an accident.
- It is forbidden to drive on public roads with the equipment suspended on the loader boom.

2.1.4 MAINTENANCE

- During the warranty period, any repairs may only be carried out by a Warranty Service authorized by the manufacturer. It is recommended that any repairs are carried out by specialized workshops.
- If any damage is found, the equipment must be taken out of service until it is repaired.
- During work on the equipment, wear appropriate, close-fitting protective clothing, gloves and appropriate tools.
- Any modification of the equipment releases PRONAR from any liability for any damage or damage to health.
- Before starting any work on the equipment, turn off the carrier's engine.
- It is forbidden to perform maintenance or repair work under the lifted and unsecured equipment.
- Perform maintenance and repair activities applying general principles of health and safety at work. In the event of a cut, the wound should be immediately washed and disinfected. In case of serious injuries consult a physician.
- Repairs, maintenance and cleaning should be performed only with the carrier's engine turned off and the ignition key removed. The vehicle must be secured with the parking brake. Secure the cab against unauthorized access.
- It is forbidden to weld, drill, cut or heat the main structural elements that directly affect the work safety.
- In the event of work requiring the equipment to be raised, use appropriate, certified lifts. After lifting the equipment, stable and durable supports must also be used.
- It is forbidden to support the equipment with fragile elements (bricks, hollow bricks, concrete blocks).
- The equipment should be kept clean in order to reduce the risk of fire).

2.1.5 WORK WITH EQUIPMENT

- Before starting the machine, make sure that there are no bystanders (especially children) or animals in the danger zone. The machine operator is obliged to ensure proper visibility of the machine and the working area.
- Before starting work, check that the side stops of the fork arms are securely fastened. Never work with forks without side stops.
- Before starting work, familiarize yourself with the surroundings and the workplace.
- It is forbidden to occupy any position other than the operator's position in the vehicle cabin while working with the equipment. It is forbidden to leave the operator's cabin while the machine is working.
- It is forbidden to stay in the working area of the equipment.
- The loader and the accessories may not be equipped with a sling, or be used for loading, unloading and assembly works with such equipment as it does not guarantee the safety of workers within the working scope.
- When working with lifted equipment, keep a safe distance from electric lines.
- Do not exceed the maximum speed of operation, which is 6 km/h.
- Load on or in the equipment should be evenly distributed.
- Do not work with the loader with the implement positioned vertically downwards.
- It is forbidden to lift the load to extreme heights on slopes. Pay attention to uneven terrain and its strength.
- It is forbidden to transport or load-unload materials for which the equipment is not intended.
- When driving with a load, avoid sharp turns and brake sharply.
- When driving with a load, the braking distance increases, so be especially careful when driving on slopes or on a slippery surface.
- It is forbidden to leave the equipment lifted and unsecured. The equipment must be lowered when parked.

- Before using the equipment each time, check its technical condition, especially in terms of safety. In particular, check the technical condition of the mounting elements.

2.2 DESCRIPTION OF RESIDUAL RISK

Pronar Sp. z o. o. in Narew made every effort to eliminate the risk of an accident. However, there is some residual risk that can lead to an accident and is primarily associated with the following activities:

- using the equipment contrary to its purpose,
- being between the lift and the equipment when the engine is running and when coupling,
- being on the equipment during engine work,
- operation of the equipment with the safety elements removed or inoperative,
- failure to maintain a safe distance from hazardous areas or occupying a place in these zones during the equipment operation,
- the equipment operation by unauthorized persons or persons under the influence of alcohol,
- cleaning, maintenance and technical inspection with connected and running carrier.

Residual risk can be reduced to a minimum by following these recommendations:

- prudent and leisurely equipment operation,
- sensible application of the remarks and recommendations contained in the operating instructions,
- performing maintenance and repair work in accordance with the principles of operating safety,
- carrying out maintenance and repair work by trained persons,
- using fitted protective clothing,

- securing the equipment carrier against access by unauthorized persons, especially children.
- keeping a safe distance from prohibited and dangerous places,
- a ban on being on the equipment while is operating.

2.3 INFORMATION AND WARNING STICKERS

All signs should always be legible and clean, visible to the user and to people who may be in the vicinity of the working machine. If any safety mark is missing or damaged, it must be replaced with a new one. All elements with safety signs and replaced with new ones during repair should be equipped with these marks. Safety marks can be purchased from the manufacturer or at the point of sale.

TABLE 2.1 Information and warning stickers

SYMBOL	DESCRIPTION
	<p>Keep a safe distance from the raised boom or equipment. Danger of crushing.</p>

Refer to for the decal locations on the equipment ***Błąd! Nie można odnaleźć źródła odwołania.***

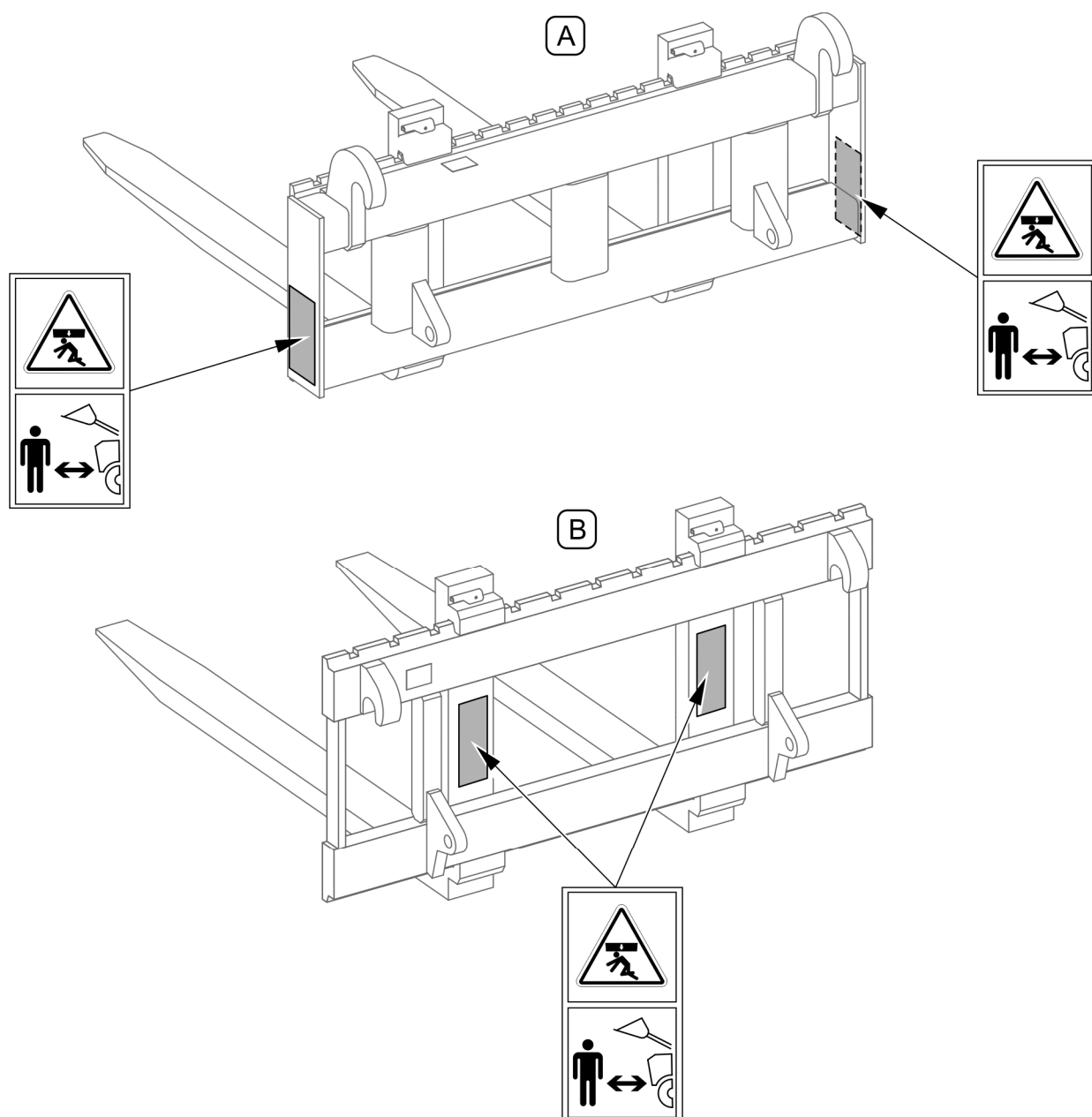

FIGURE 2.1 Arrangement of warning stickers

(A) - pallet fork 35WP / 35WP1 / 35WP2; (B) - WP-25E pallet forks;;

The description of the meaning of the symbols is presented in TABLE 2.1

SECTION

3

**DESIGN AND
OPERATION**

3.1 TECHNICAL CHARACTERISTICS

TAB. 3.1 GENERAL TECHNICAL DATA

	Unit				
Name	–	Pallet fork			
Model	–	35WP1	35WP	35WP2	WP-25E
Load capacity	kg	1,650			2,500
Carrier class according to ISO 2328	–	2A			3A
Width	mm	1,200			1,200
Height	mm	590			655
Length	mm	1,350			1,390
Depth of fork arm	mm	1,100			1,200
Weight	kg	175			226
Arms spacing	mm	120 ÷ 1080 (in 60mm increments)			180 ÷ 1080 (in 90mm increments)
The method of attachment	–	EURO	ŁC-1650	SMS	EURO EURO SMS JCB2CX WEIDEMANN 2070CX50

The noise level of the machine shall not exceed 70 dB(a)

3.2 GENERAL CONSTRUCTION

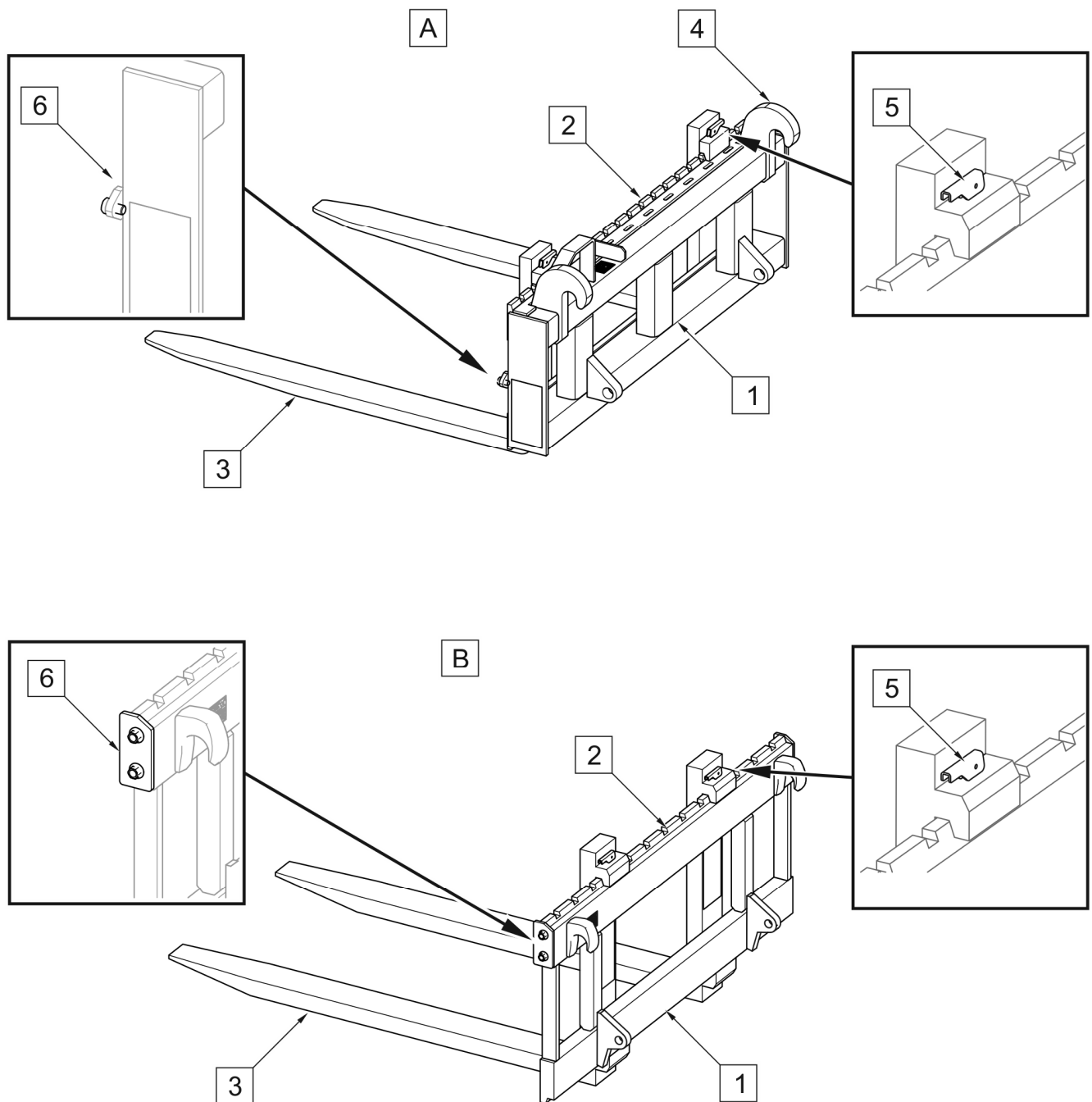

FIG. 3.1 General construction

(A) - pallet forks model 35WP / 35WP1 / 35WP2; (B) - pallet forks model WP-25E;

(1) - frame; (2) - carriage guides; (3) - sliding arms; (4) - fastening elements; (5) - slide lock lever; (6) - side stop of the arms

The 35WP, 35WP1 and 35WP2 pallet forks have a frame (1) equipped with attachment elements (4) with front loader. The guides (2), so-called carriage, are welded to the frame for

securing two sliding arms (3). The track width is changed in 60 mm increments when the slide lock lever (5) is unlocked.

On WP-25E forks, the clamping elements (4) are welded directly to the guide (2) of the so-called carriage. The arms spacing (2) can be changed in increments of 90 mm.

Depending on the model, pallet forks are equipped with guides according to ISO 2328 class 2A (*pallet forks model 35WP / 35WP1 / 35WP2*) or class 3A (*pallet forks model WP-25E*).

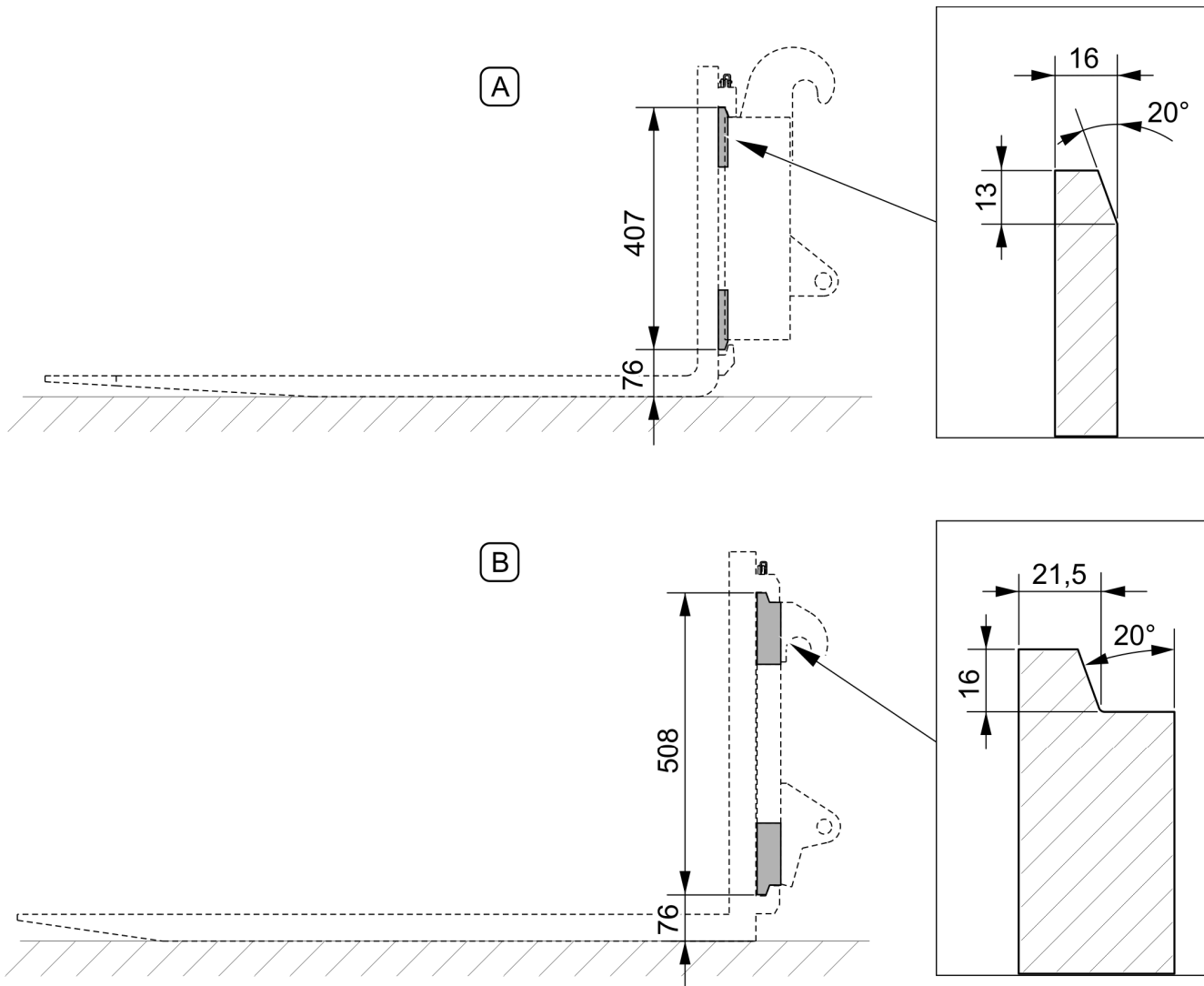

FIG. 3.2 Dimensions of guides (carriage) for attaching fork arms according to ISO
 (A) - Class 2A carriage (*applicable to 35WP / 35WP1 / 35WP2*); (B) - Class 3A carriage (*applicable to WP-25E*)

The dimensions are in millimeters [mm]

SECTION

4

CORRECT USE

4.1 PREPARATION TO WORK

DANGER



Before using the equipment, the user should carefully read the contents of this manual , as well as the manual of the loader with which it works.

Careless and improper use and operation of the equipment, and non-compliance with the recommendations given in this operator's manual is dangerous to the health of the operator and other people.

The equipment must not be used by persons who are not authorized to drive agricultural tractors (carriers), including children and people under the influence of alcohol or other drugs.

Before starting the carrier with the equipment, make sure , that there are no bystanders in the danger zone.

The manufacturer ensures that the equipment are fully operational and have been checked according to inspection procedures and are ready for use. However, this does not release the user from the obligation to check the the equipment after delivery and before first use. The equipment is delivered to the user completely assembled. Before connecting to the carrying vehicle, the operator must check the technical condition of the the equipment. To do this:

- read the contents of this manual and follow the recommendations contained therein, learn about the structure and understand the use of the equipment,
- check the compatibility of the equipment mounting system with the loader mounting system , with which it is to be aggregated,
- check the condition of the paint coating,
- carry out a visual inspection of individual machine components in terms of mechanical damage resulting from among others due to improper transport of the machine (dents, punctures, bends or broken details),
- check the technical condition of the elements coupling with the loader.



CAUTION

Non-adherence to the recommendations contained in the manual may cause damage to the the equipment.

If all the activities described above have been performed and the technical condition of the attachment raises no objections, it should be connected to the carrying vehicle (see 4.2 ATTACHING TO THE LOADER)

In the event of malfunctions in operation, stop using immediately, locate and remove the fault. If the defect cannot be removed or its removal may void the warranty, contact the seller or the manufacturer directly to clarify the problem.

**CAUTION**

Before using the equipment each time, check its technical condition. In particular, check the technical condition of the loader attachments and the fork travel stops and locks.

4.2 ATTACHING OF THE EQUIPMENT TO THE LOADER

The equipment can be combined with a loader that meets the requirements of table 1.1 FRONT LOADER REQUIREMENTS.

**CAUTION**

Before connecting the implement to the loader, read the operating instructions for both the loader and carrying vehicle.

**DANGER**

During coupling, there must be no people between the equipment and the loader.
Be especially careful during the coupling the equipment to the loader.

Before hitching the equipment to the loader, check that the equipment attachment system is compatible with that of the loader.

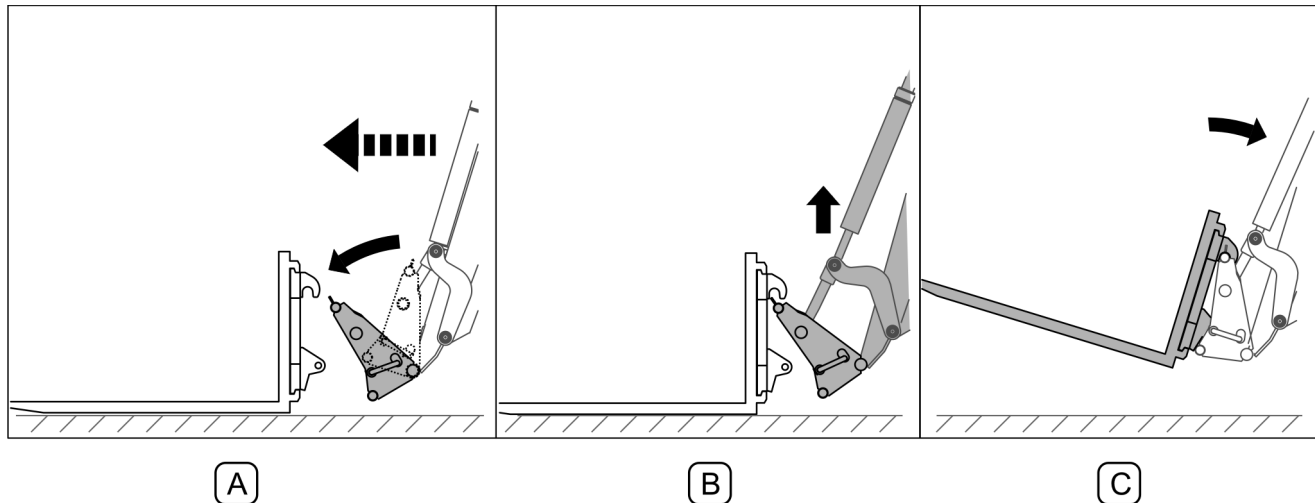

FIG. 4.1 Connecting to the front loader

(A), (B), (C) - consecutive stages of coupling

When connecting the equipment with the front loader (FIG. 4.1):

- unlock the mechanism fastening the tool in the loader frame (*depending on the type of loader*),
- lower the boom and rotate the frame downwards (A) so that the mounting points on the mounting frame are below the mounting hooks in the equipment,
- drive the loader to the equipment and insert the fixing points to the appropriate places in the loader frame,
- raise the boom (B) so that the upper mounting points are within the hooks of the equipment,
- by controlling the boom, tilt the frame back (C) causing the clamping mechanism to block (*depending on the type of loader*),
- check the correctness of mounting, block the quick-mounting mechanism(*depending on the type of loader*).

The described method of connection (FIG. 4.1) is indicative and may differ depending on the model of the loader (carrier). The description of how to attach the working tools is provided in the front loader operating manual (carrier).

4.3 WORK WITH EQUIPMENT



DANGER

It is forbidden to transport people in the loader equipment.

It is forbidden to stay within the range of the working equipment.

The loader equipment can only be controlled from the operator's cabin.

When working with a loader with forks, pay attention to the most favourable position of the means of transport or the place of unloading in relation to the place of loading. The distance should be selected so that maneuvering the loader takes place along the shortest possible path. When driving with a loaded attachment, a maximum travel speed of 6 km/h and the lowest possible position of the work tool are permitted. Raising of the attachment to the desired height and finishing the work can be done only at the unloading site.



DANGER

Do not operate attachments with the fork arm travel lock open (FIG. 4.2).

It is forbidden to operate attachments without the side stops of the fork arms (FIG. 4.3).

Avoid ruts, depressions, ditches, or driving along roadside slopes. Driving over such obstacles may cause the carrier with the loader to suddenly tilt. Driving near the edges of ditches or canals is dangerous due to the risk of landslides under the wheels of vehicle. The travel speed should be reduced sufficiently in advance of driving to curves, when driving on uneven or sloping terrain.

During work requiring greater precision in guiding the implements, it is recommended to use the implement level indicator (*if present in the loader*).



CAUTION

Do not permissible front loader load capacity and the permissible front axle loads of the carrying vehicle.

Do not exceed the maximum working speed - 6 km/h

If the front loader has hydraulic suspension, it is recommended to disengage the suspension when working with pallet forks (*if possible*).

**CAUTION**

Do not approach loads at high speed. Make sure that the load is stable before lifting. Stop centrally in front of the load and place the load on the forks as you move forward.

Example of a loader (carrier) duty cycle with pallet forks:

- Check the required fork prong spacing and adjust if necessary. Position the fork arms symmetrically.
- Drive to the loading area with the forks slightly raised and place the fork arms in front of the pallet at a suitable height, parallel to the ground (*it is recommended to use the attachment level gauge – if fitted to the loader*).
- Guide the fork arms into the correct position on the pallet by driving the tractor slowly forward, raise the load to the minimum height and tilt the forks backwards.
- Drive to the unloading area with the forks raised to the minimum height, without making sudden turns or braking.
- Position the forks with the load horizontally at the required height.
- Lower the forks with the load to the ground and fully extend the fork arms out of the pallet by withdrawing with the carrier.
- Raise the forks to the minimum height and drive to the loading area.

**CAUTION**

Make sure that the load is secured correctly and is in the center of the forks. Do not lift loads using only one fork arm.

**DANGER**

Do not leave a load on the raised forks. The forks must be lowered when parked.

**DANGER**

Stop the engine in the carrier and apply the parking brake before adjusting the attachment.

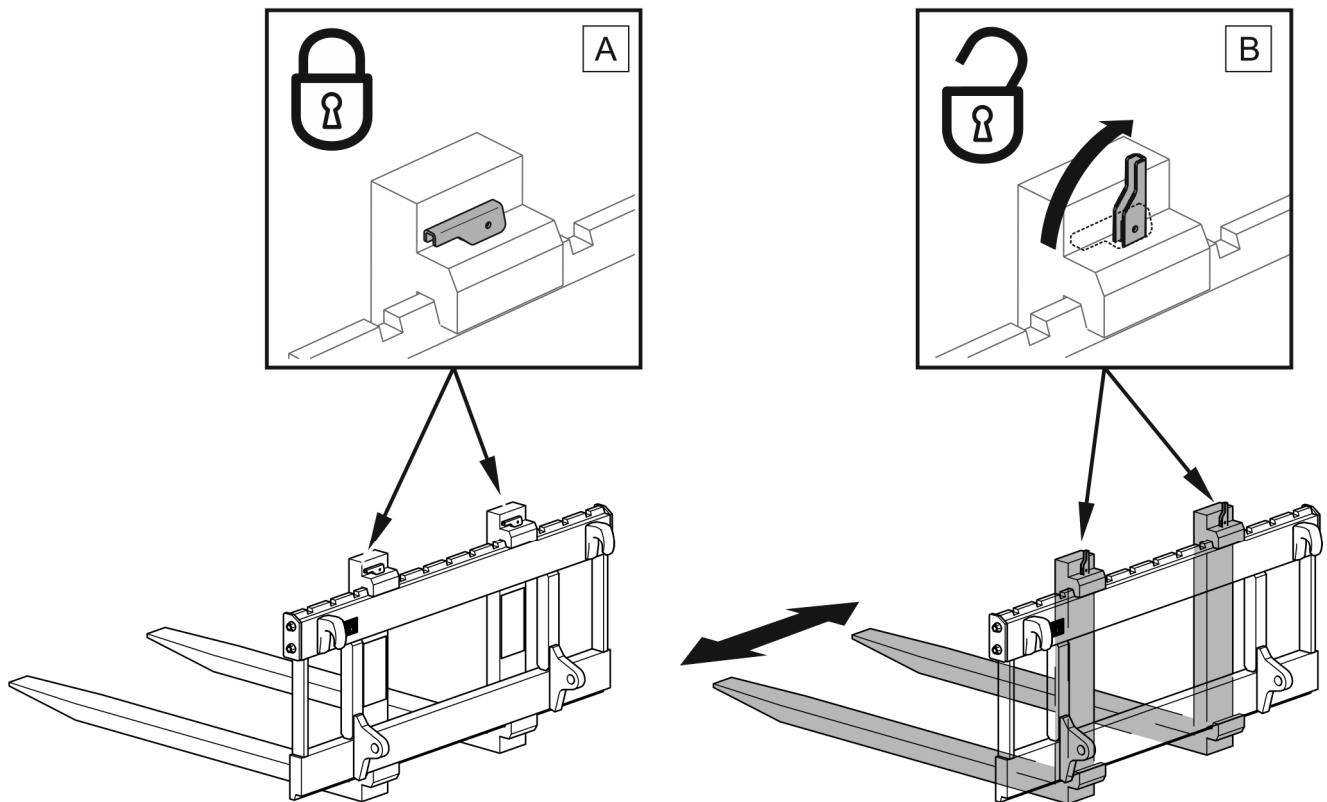

FIG. 4.2 Changing of the fork arms spacing

(A) - slide lock closed; (B) - slide lock open; (1) - arm; (2) - slide lock lever

Pallet forks (35WP1 / 35WP1 / 35WP2) allow the fork arms spacing to be changed in increments of 60 mm and WP-25E forks in increments of 90 mm.

To change the fork spacing (FIG. 4.2):

- Raise the forks slightly, stop the engine and apply the parking brake on the carrier.
- Position the slide lock lever vertically (B).
- Move the arms to the desired spacing, ensuring that both arms are spaced out symmetrically.
- Close the lock lever by turning it horizontally (a). If the locking lever does not release, gently move the arm to the right or left until it is closed.
- Check that it locks correctly by trying to move the arm sideways.

**DANGER**

When working with attachments, the arm lock must be closed (FIG. 4.2, A)

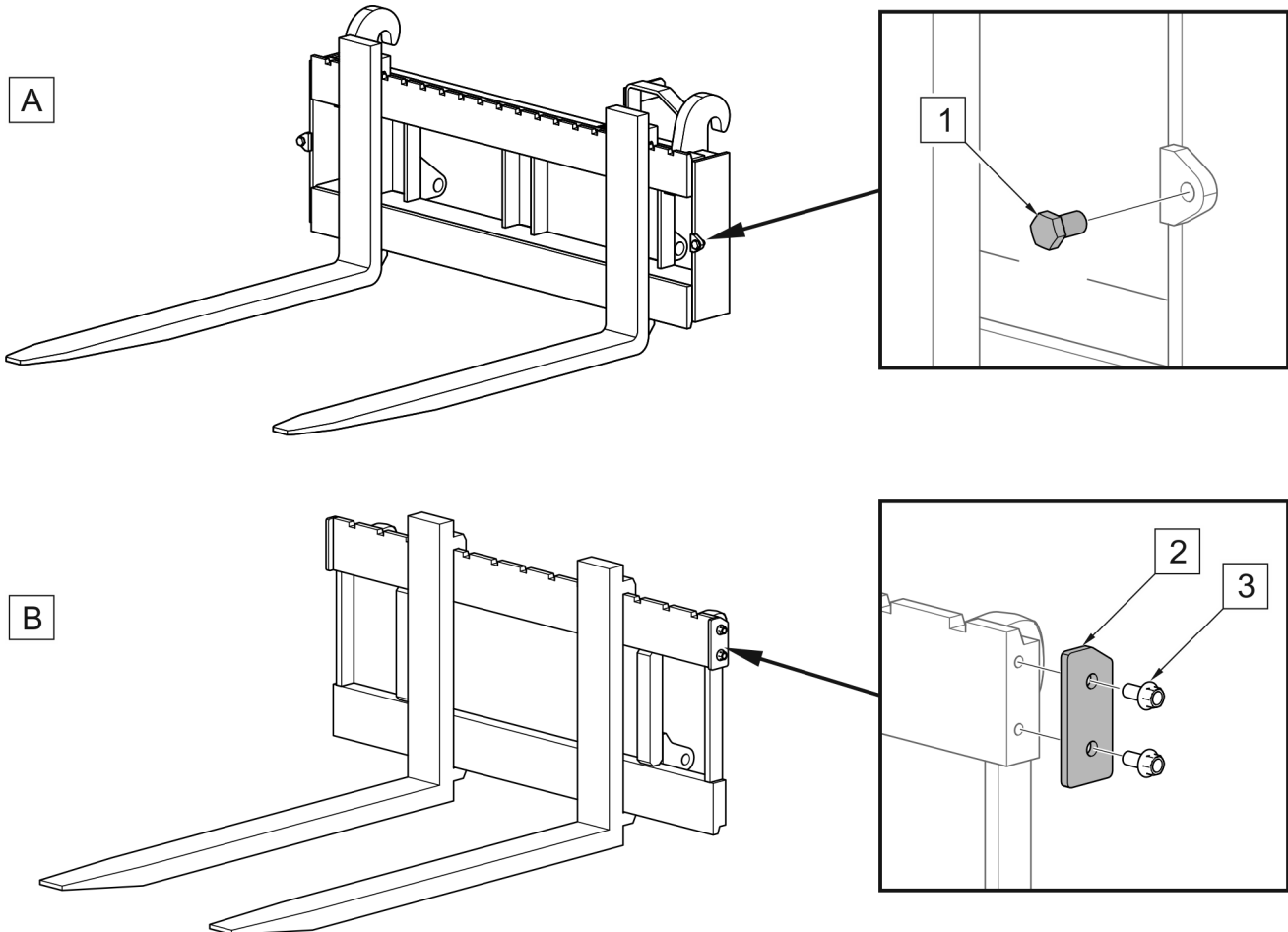

FIG. 4.3 The side stops of the fork arms

(A) - pallet fork model 35WP / 35WP1 / 35WP2; (B) - pallet fork model WP-25E;
 (1) - screw M12x20-8.8; (2) - locking plate; (3) - screw M12x25-8.8

The fork arms are secured against excessive lateral movement by means of side travel stops (FIG. 4.3) located on both sides of the frame. To remove the fork arms 35WP1 / 35WP1 / 35WP2, remove the locking screw (1). To remove the WP-25E fork arms, unscrew the screws (3) and remove the locking plate (2). The lateral stop for the arms should be installed during operation.

**DANGER**

It is forbidden to operate attachments without the side stops of the fork arms(FIG. 4.3)

4.4 UNCOUPLING EQUIPMENT FROM THE LOADER

Before removing the equipment from the loader, it must be emptied. The equipment should be disconnected placed in a such place, that it is possible to connect it again. Before lowering the equipment to the ground, it must be level.

**DANGER**

Exercise extreme caution when disconnecting equipment from the loader.

In order to dismantle the equipment from the loader:

- lower the boom until the bucket rests on the ground, turn off the engine,
- unlock the mechanism fastening the tool in the loader frame
- start the carrying vehicle and tilt the extension frame forward until the frame bars come out of the equipment hooks, drive the loader away from the equipment.

Once disconnected from the loader, the equipment should not be moved or carried by any other loader attachment, except for the pallet fork when the equipment is attached to the pallet.

4.5 TRANSPORT PASSAGE

**DANGER**

It is forbidden to drive on public roads with equipment attached to the loader.

SECTION

5

MAINTENANCE

5.1 MAINTENANCE AND STORAGE



DANGER

Do not perform service or repair work under the loaded or raised implement.

After finishing work, implement should be thoroughly cleaned and washed with water jet. While washing do not direct a strong water or steam jet at information and warning decals, bearings or hydraulic lines. Nozzle of pressure or steam washer should be kept at a distance of not less than 30 cm from cleaned surface.

After cleaning, inspect the implement, inspect technical condition of individual elements. Worn or damaged elements should be replaced.



ATTENTION!

Should it be necessary to change individual parts, use only original parts or those indicated by the Manufacturer. Non-adherence to these requirements may put the user and other people's health and life at risk, and also damage the machine.

It is recommended to keep the implement in a closed or roofed building.

If the implement shall not be used for a long period of time, protect it against adverse weather conditions. In order to protect against corrosion, grease the mounting points of the front loader before the winter.

Pallet forks do not require periodic lubrication. However, if moving the forks when adjusting spacing is difficult, clean the fork guides (carriage) of dirt and apply a thin layer of LT-42 or LT-43 grease.

5.2 TROUBLESHOOTING

TABLE 5.1 TROUBLESHOOTING

TYPE OF FAULT	CAUSE	REMEDY
Impossible to adjust fork spacing	Sliding lock mechanism engaged	Disengage the sliding lock mechanism (set the lock lever vertically), adjust the spacing, engage the lock and check if the lock is correctly engaged
	Fork guides (carriage) contaminated	Clean the fork guides and apply a thin layer of grease.

NOTES

[illegible]